

# LOOKOUT POINT AND PLAZA



# AQUARIUM AND MARINE CENTRE



# AQUARIUM AND MARINE CENTRE

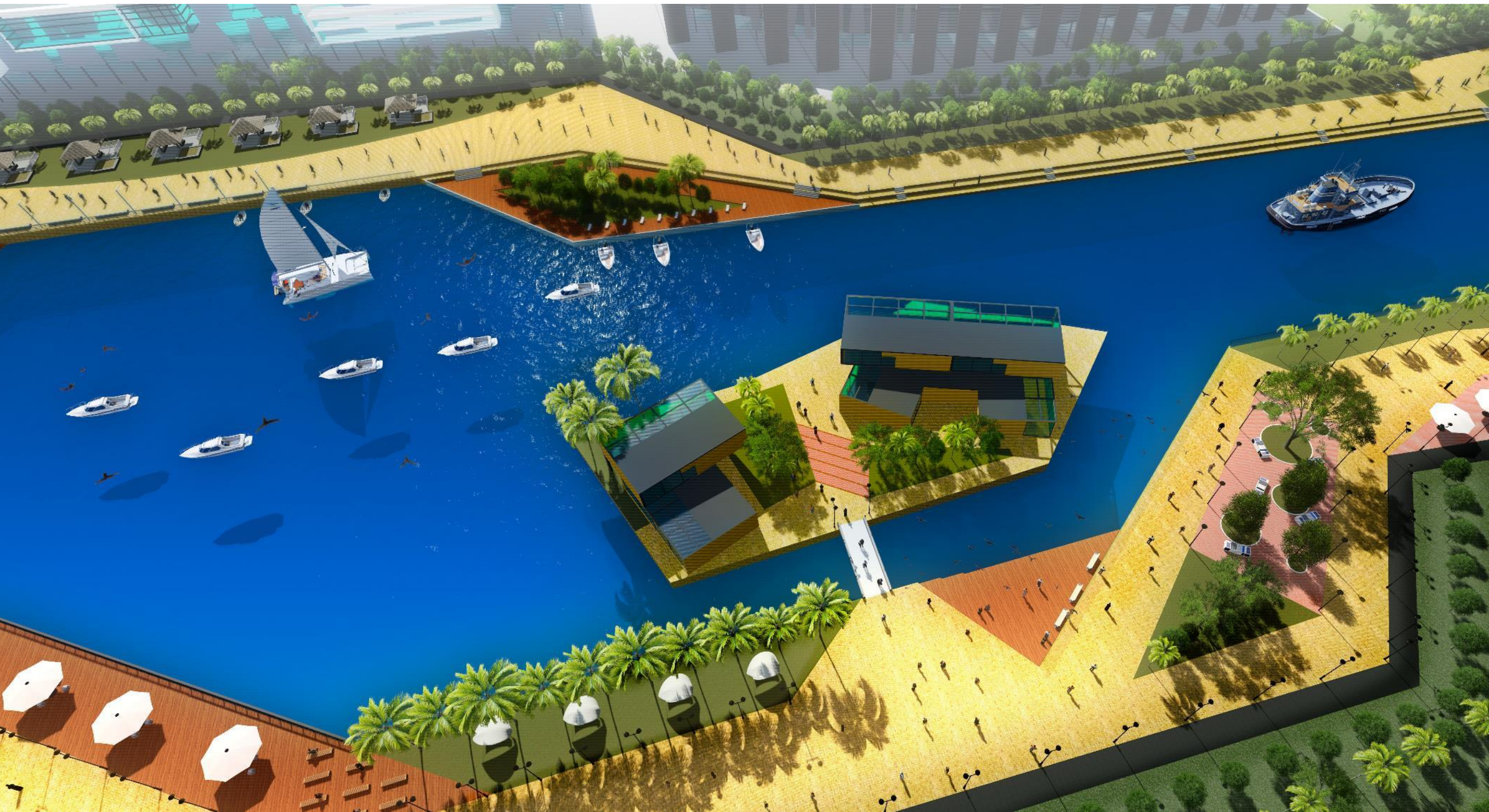

# LANDSCAPE NETWORK



# TRANSPORT NETWORK



**LEGEND**  
**TRANSPORTATION NETWORK**

- PROPOSED TRAIN TRACE
- MAIN ROAD CIRCULATION
- SCENIC ROAD AREA
- WATER TAXI AND BOATS
- CRUISE SHIP

# LAND USE

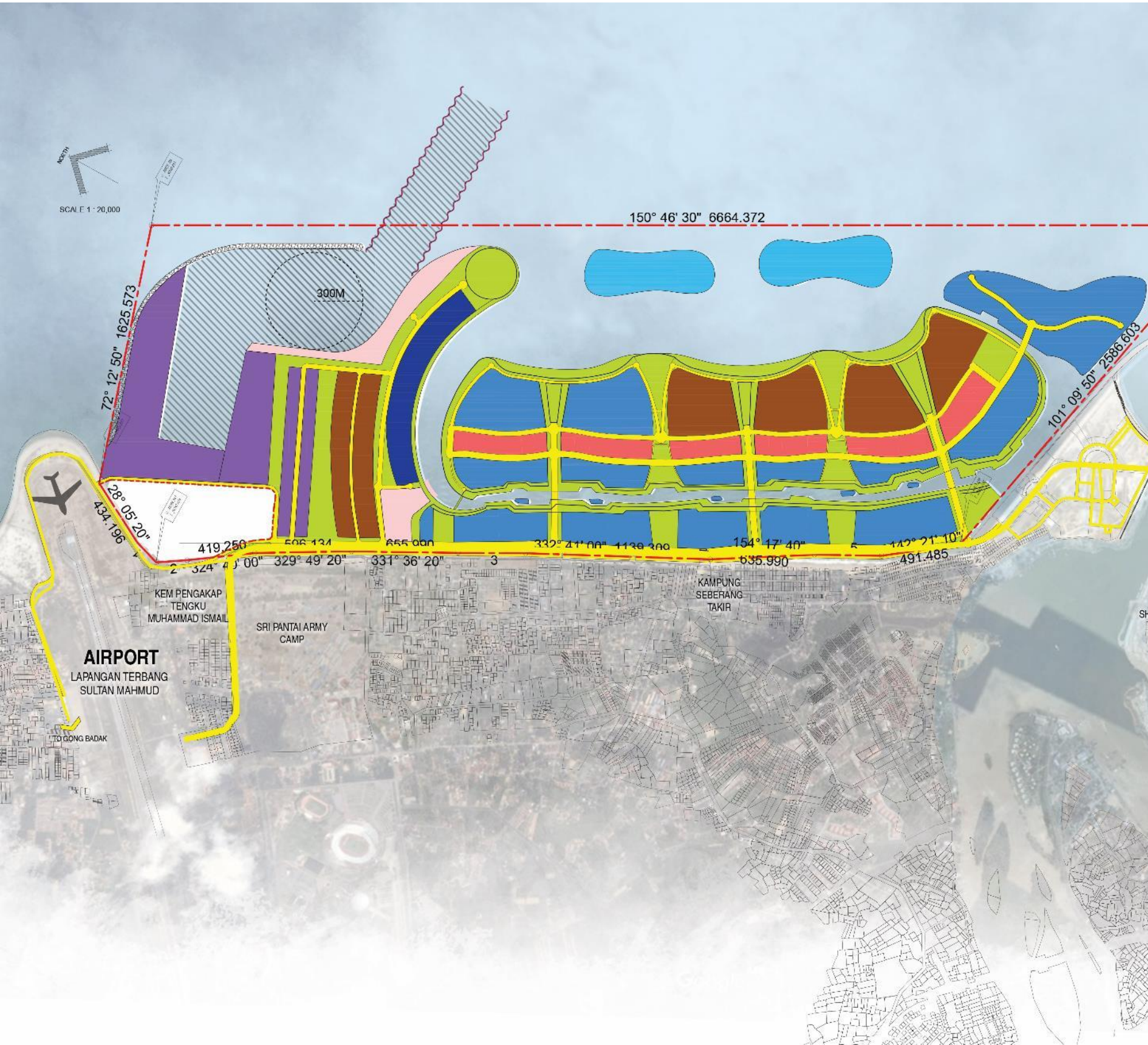











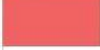

## SUMMARY OF LAND USE

LAND USE	ACRE	%
<b>RESIDENTIAL</b>		
MIX RESIDENTIAL	208.54	
<b>TOTAL</b>	208.54	13.17
<b>COMMERCIAL</b>		
TOWN CENTRE	50.00	
MIX DEVELOPMENT	460.46	
HOTEL AND RESORT	100.00	
<b>TOTAL</b>	610.46	14.49
<b>INDUSTRY</b>		
INDUSTRY AND LOGISTIC	40.30	
MARINE FACILITIES	150.0	
<b>TOTAL</b>	190.3	6.43
<b>RECREATION AND LANDSCAPE</b>		
OPEN PUBLIC SPACE	387.8	
<b>TOTAL</b>	387.8	13.10
<b>PUBLIC EASENESS</b>		
PUBLIC FACILITIES	91.0	
<b>TOTAL</b>	91.0	3.07
<b>INFRASTRUCTURE AND UTILITY</b>		
TRANSPORT HUB	18.25	
CRUISE LINEAR TERMINAL	37.75	
ROAD RESERVE	231.0	
UTILITY AND SERVICES	98.0	
BREAK WATER BARRIER	17.0	
<b>TOTAL</b>	402.0	13.90
<b>TOTAL LAND FOR DEVELOPMENT</b>	1890	
<b>WATER BODY</b>		
SOUTH CHINA SEA	1100	37.16
<b>GRAND TOTAL</b>	2990	100

# LAND USE SUMMARY

## SUMMARY OF LAND USE

LAND USE	ACRE	%
<b>RESIDENTIAL</b>		
 MIX RESIDENTIAL	208.54	
<b>TOTAL</b>	208.54	13.17
<b>COMMERCIAL</b>		
 TOWN CENTRE	50.00	
 MIX DEVELOPMENT	460.46	
 HOTEL AND RESORT	100.00	
<b>TOTAL</b>	610.46	14.49
<b>INDUSTRY</b>		
 INDUSTRY AND LOGISTIC	40.30	
 MARINE FACILITIES	150.0	
<b>TOTAL</b>	190.3	6.43
<b>RECREATION AND LANDSCAPE</b>		
 OPEN PUBLIC SPACE	387.8	
<b>TOTAL</b>	387.8	13.10
<b>PUBLIC EASENESS</b>		
 PUBLIC FACILITIES	91.0	
<b>TOTAL</b>	91.0	3.07
<b>INFRASTRUCTURE AND UTILITY</b>		
 TRANSPORT HUB	18.25	
 CRUISE LINEAR TERMINAL	37.75	
 ROAD RESERVE	231.0	
 UTILITY AND SERVICES	98.0	
 BREAK WATER BARRIER	17.0	
<b>TOTAL</b>	402.0	13.90
<b>TOTAL LAND FOR DEVELOPMENT</b>	1890	
<b>WATER BODY</b>		
 SOUTH CHINA SEA	1100	37.16
<b>GRAND TOTAL</b>	2990	100

## JADUAL GUNA TANAH

GUNA TANAH	EKAR	%
<b>PERUMAHAN</b>		
 PERUMAHAN BERCAMPUR	208.54	
<b>JUMLAH</b>	208.54	13.17
<b>PERDAGANGAN</b>		
 PUSAT BANDAR	50.00	
 PEMBANGUNAN BERCAMPUR	460.46	
 HOTEL DAN RESORT	100.00	
<b>JUMLAH</b>	610.46	14.49
<b>INDUSTRI</b>		
 INDUSTRI DAN LOGISTIK	40.30	
 FASILITI MARIN	150.0	
<b>JUMLAH</b>	190.3	6.43
<b>KAWASAN REKREASI / LANSKAP</b>		
 KAWASAN LAPANG	387.8	
<b>JUMLAH</b>	387.8	13.10
<b>KEMUDAHAN MASYARAKAT</b>		
 KEMUDAHAN MASYARAKAT	91.0	
<b>JUMLAH</b>	91.0	3.07
<b>INFRASTRUKTUR DAN UTILITI</b>		
 HUB PENGANGKUTAN	18.25	
 TERMINAL 'CRUISE LINEAR'	37.75	
 RIZAB JALAN	231.0	
 RIZAB UTILITI	98.0	
 TEMBOK PEMECAH OMBAK	17.0	
<b>JUMLAH</b>	402.0	13.90
<b>JUMLAH PEMBANGUNAN</b>	1890	
<b>BADAN AIR</b>		
 LAUT CHINA SELATAN	1100	37.16
<b>JUMLAH BESAR</b>	2990	100

# STAGING PLAN

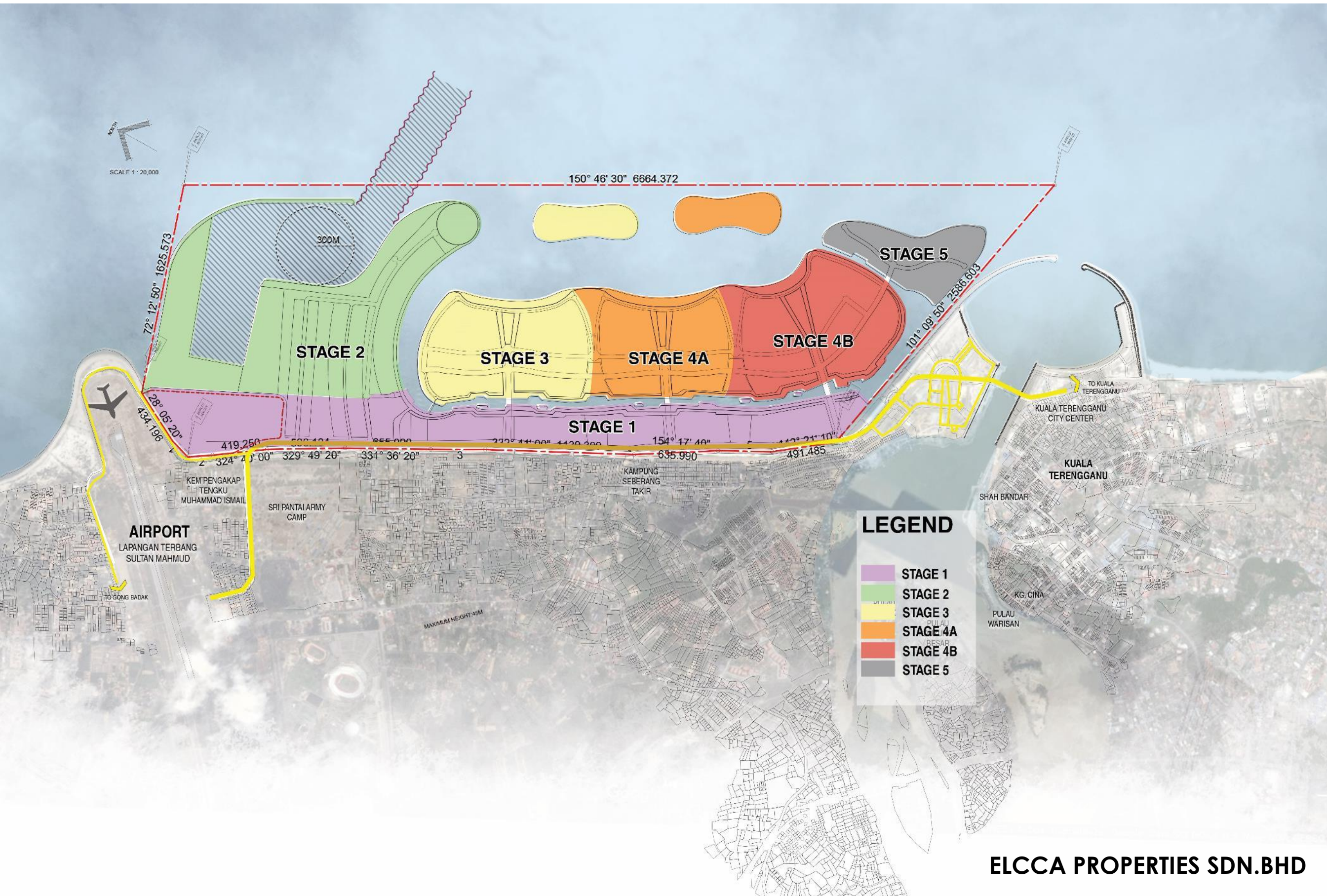



# CROSS SECTION

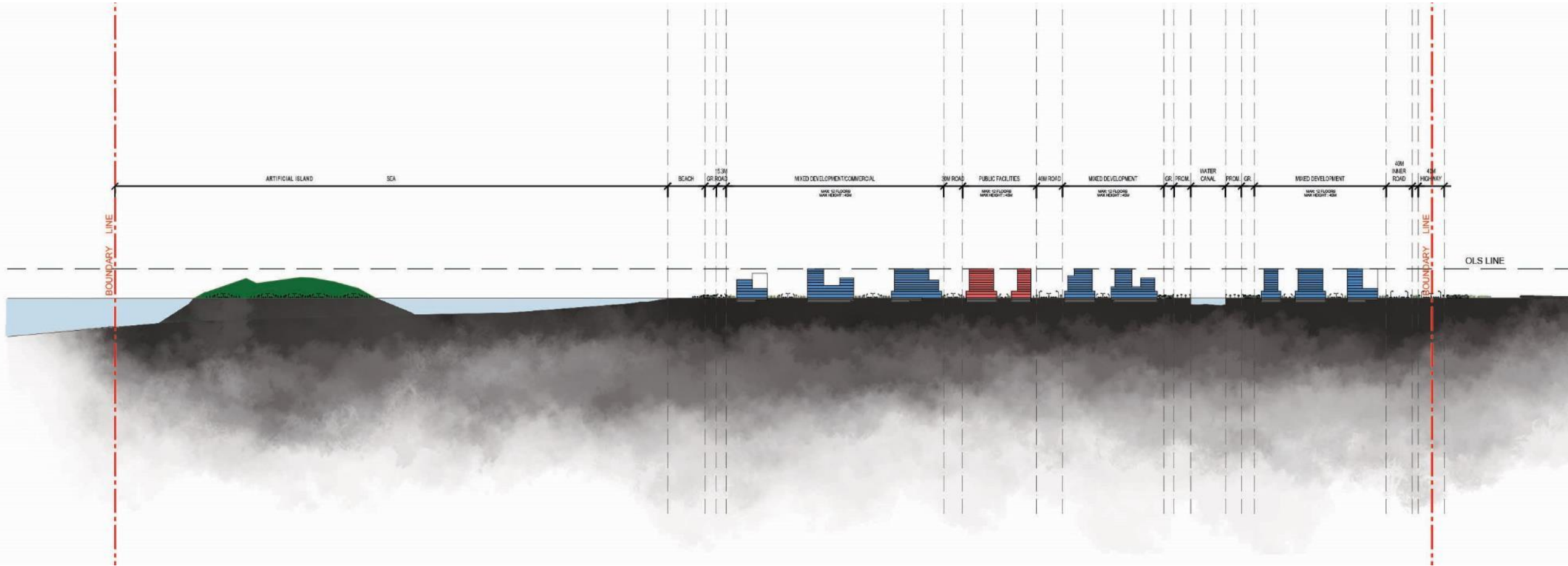

SECTION B-B

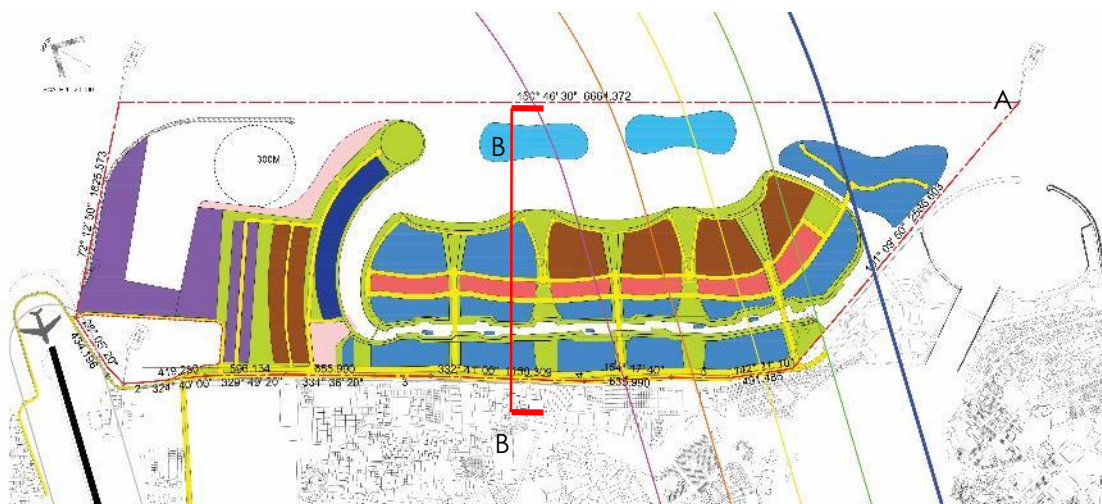

KEY PLAN

# 3D PERSPECTIVE VIEWS

