



MALAYSIAN STANDARD

MS 2039:2006

ADDRESSES - STANDARD FORMAT - REQUIREMENTS

ICS: 35.240.70

Descriptors: addresses, requirements, street addresses, non-street addresses, post office box addresses

© Copyright 2006

DEPARTMENT OF STANDARDS MALAYSIA

DEVELOPMENT OF MALAYSIAN STANDARDS

The **Department of Standards Malaysia (DSM)** is the national standardisation and accreditation body.

The main function of the Department is to foster and promote standards, standardisation and accreditation as a means of advancing the national economy, promoting industrial efficiency and development, benefiting the health and safety of the public, protecting the consumers, facilitating domestic and international trade and furthering international cooperation in relation to standards and standardisation.

Malaysian Standards are developed through consensus by committees which comprise of balanced representation of producers, users, consumers and others with relevant interests, as may be appropriate to the subject in hand. To the greatest extent possible, Malaysian Standards are aligned to or are adoption of international standards. Approval of a standard as a Malaysian Standard is governed by the Standards of Malaysia Act 1996 (Act 549). Malaysian Standards are reviewed periodically. The use of Malaysian Standards is voluntary except in so far as they are made mandatory by regulatory authorities by means of regulations, local by-laws or any other similar ways.

The Department of Standards appoints **SIRIM Berhad** as the agent to develop Malaysian Standards. The Department also appoints SIRIM Berhad as the agent for distribution and sale of Malaysian Standards.

For further information on Malaysian Standards, please contact:

Department of Standards Malaysia
Level 1 & 2, Block C4, Parcel C
Federal Government Administrative Centre
62502 Putrajaya
MALAYSIA

Tel: 60 3 88858000
Fax: 60 3 88885060

<http://www.dsm.gov.my>

E-mail: central@dsm.gov.my

OR **SIRIM Berhad**
(Company No. 367474 - V)
1, Persiaran Dato' Menteri
P.O. Box 7035, Section 2
40911 Shah Alam
Selangor D.E.

Tel: 60 3 5544 6000
Fax: 60 3 5510 8095

<http://www.sirim.my>

CONTENTS

	Page
Committee representation	iv
Foreword	vi
1 Scope	1
2 Terms and definitions	1
3 Ensuring consistency and responsibility	2
4 Address syntax.....	3
4.1 Address dataset	3
4.2 Usage of postcode number.....	4
4.3 International and other usage.....	4
4.4 Single address component	4
4.5 Usage of comma.....	5
4.6 Usage of prefixes	5
4.7 Address for parcel or unit in multi-storey building.....	6
5 Street addresses.....	8
5.1 General.....	8
5.2 Requirements for street addresses.....	8
5.3 Application.....	11
6 Non-street addresses	12
6.1 General.....	12
6.2 Requirements for non-street addresses	12

CONTENTS (continued)

	Page
7 Post office box addresses	14
7.1 General.....	14
7.2 Requirements for post office addresses.....	14
 Tables	
1 Address dataset	3
2 Common mistake in postcode usage.....	4
3 Single address component.....	4
4 Usage of comma	5
5 Usage of prefixes	5
6 Missing prefixes	5
7 Address for parcel or unit in multi storey building.....	6
8 Types of street addresses	8
9 Receiver/habitation name for street addresses.....	9
10 Hypens in range/number on street name	10
11 Double abbreviations.....	10
12 Numeric street names.....	11
13 House number or street number location	11
14 Types of non-street addresses.....	13
15 Receiver/habitation name for non-street addresses.....	13
16 Receiver/habitation name for post office box addresses.....	14
17 Incomplete prefixes for post office box address	15

CONTENTS (continued)

	Page
A1 Street prefixes.....	16
A2 Post office box prefixes	17
A3 Locality prefixes	17
A4 Government prefixes	18
A5 Firm abbreviation	18
A6 Building abbreviation.....	19
A7 Other abbreviation.....	19
B1 Postcode assignment	20
C1 List of postcode number.....	25
D1 Common mistake for underlined and guided address in postal purposes	34
D2 Common mistake for English translation.....	34
D3 Common mistake for "off street" address.....	35
D4 Common mistake for dual address.....	35
D5 Milestone location	35
Figure 1 Strata convention for parcel or unit in multi-storey building.....	7
 Annexes	
A List of prefixes and abbreviations.....	16
B Postcode system.....	20
C List of postcode number	25
D Common mistakes used in addresses.....	34
 Bibliography.....	 36

MS 2039:2006

Committee representation

The Information Technology, Telecommunication and Multimedia Industry Standards Committee (ISC G) under whose authority this Malaysian Standard was developed, comprises representatives from the following organisations:

Association of Consulting Engineers Malaysia
Association of the Computer and Multimedia Industry of Malaysia
Department of Standards Malaysia
Federation of Malaysian Manufacturers
Institut Tadbiran Awam Negara
Malaysian Administrative, Modernisation and Management Planning Unit
Malaysian Communications and Multimedia Commission
Malaysian Industry-Government Group for High Technology
Malaysian National Computer Confederation
MIMOS Berhad
Ministry of Defence
Ministry of Domestic Trade and Consumer Affairs
Ministry of Energy, Water and Communications Malaysia
Ministry of International Trade and Industry
Ministry of Science, Technology and Innovation
Multimedia University
SIRIM Berhad
Telekom Malaysia Berhad
The Institution of Engineers, Malaysia
Universiti Teknologi Malaysia
Universiti Tun Abdul Razak

The Technical Committee on Geographic Information/Geomatics which supervised the development of this Malaysian Standard consists of representatives from the following organisations:

Department of Survey and Mapping Malaysia
ESRI South Asia Sdn Bhd
Geo-Info Services
Malaysian Access Centre and Remote Sensing
Malaysian Agriculture Research and Development Institute
Malaysian Centre for Geospatial Data Infrastructure
Ministry of Natural Resources and Environment
Public Work Department
SIRIM Berhad (Secretariat)
Town and Country Planning Department
Universiti Sains Malaysia
Universiti Teknologi Malaysia

Committee representation *(continued)*

The Working Group on Route Information, Guide Signs and Addresses which developed this Malaysian Standard consists of representatives from the following organisations:

Automobile Association of Malaysia

Department of Survey and Mapping Malaysia

ESRI South Asia Sdn Bhd

Ministry of Housing and Local Government

Pos Malaysia Berhad

Public Work Department

Road Engineering Association of Malaysia

SIRIM Berhad (Secretariat)

Subang Jaya Municipal Council

Town and Country Planning Department

Universiti Malaya

Universiti Putra Malaysia

Universiti Teknologi Malaysia

MS 2039:2006

FOREWORD

This Malaysian Standard was developed by the Working Group on Route Information, Guide Signs and Addresses under the authority of the Information Technology, Telecommunication and Multimedia Industry Standards Committee.

Compliance with a Malaysian Standard does not of itself confer immunity from legal obligations.

ADDRESSES – STANDARD FORMAT - REQUIREMENTS

1. Scope

This Malaysian Standard provides requirements for standard addresses to ensure consistency in formatting addresses for postal purposes and databases.

This standard classified the address into the following types:

- a) street addresses;
- b) non-street addresses; and
- c) post office box addresses.

2. Terms and definitions

For the purposes of this standard, the following terms and definitions apply.

2.1 Address

Information identifying a specific premise or geographic features, except for post office box which is defined in 2.11.

2.2 Address component

A distinct part of data that formed a complete address.

2.3 Address syntax

The arrangement of address components to form a complete address.

2.4 Cityname

A place or area assigned with a postcode number or a group of postcode numbers. For example, Kuala Kangsar, Tanjung Malim, Muar, Ipoh, etc.

Refer to Annex C for list of other cityname.

2.5 Council

A body elected or appointed to govern a particular area, town or city and provide services.

2.6 Dual address

An address that is formed by two types of address information.

MS 2039:2006

2.7 Habitation

The act of living in an area or a building.

2.8 Locality

A particular area described by sub-location, sub-city or city.

2.9 Prefix

A word added to the beginning of an address component.

2.10 Private road

A road handed over to private entity to be constructed and maintained.

2.11 Post office box

Letter boxes numbered and placed in post office and rented to individual or organisations.

2.12 Postcode

A five-numeric character, which is assigned to one or more postal addresses in a specific delivery area, post boxes, government department and etc. It is an integral part of every postal address in Malaysia, which is used to identify the various processing/delivery facilities and post offices.

NOTE. Refer to Annex B for postcode numbering system used by Pos Malaysia Berhad.

2.13 Sub-location

A location within a sub-city e.g. Kampung Baru, Taman Miharja, etc.

2.14 Sub-city

A location within a city e.g. Ampang, Cheras, etc.

3. Ensuring consistency and responsibility

In order to ensure standardisation and consistency, the following principles should be applied to habitation naming such as street name, sub-location name, building name and government agency:

a) State/territorial/national agencies

The custodial responsibility of agencies shall be fulfilled by ensuring the currency, accuracy and quality of data are maintained.

b) Local governments

Local governments shall be responsible for addressing consistency and support address numbering integrity by referring to this standard.

NOTE. For existing and new names for gazetted geographic names, refer to the Committee on National Geographic Name (*Jawatankuasa Kebangsaan Nama Geografi*) on Geography Names Determination Guideline.

4. Address syntax

Addresses should follow the rules stated below.

4.1 Address dataset

Table 1. Address dataset

No	Component	Order	Street address	Non-street address	Post office box
1	Receiver/Owner (firm/government agencies/individual)	1	O	O	O
	Room/unit/level number		O	O	O
	Building/premise name		O	O	O
2	Street number	2	M	-	-
	Premise number		-	M	-
	P. O. Box		-	-	M
3	Street name	3	M	-	-
4	Locality	4	M	M	-
5	Postcode	5	M	M	M
6	Cityname NOTE. See 2.4	6	M	M	M
7	State	7	F	F	F
8	Country	8	F	F	F
Legend M : Mandatory requirement O : Optional (when applicable) F : For international communication and other usage - : Not required					

MS 2039:2006

4.2 Usage of postcode number

Postcode number shall be used in the correct syntax and location in an address. It should be placed before a cityname, not a state or a sub-location name as shown in Table 2. There should be a space between the postcode and the cityname.

Table 2. Common mistake in postcode usage

Common mistake	Incorrect	Correct
The usage of postcode in a sub-location	No 1 Jalan Sutra 1 55100 Taman Sutra Kuala Lumpur	1, Jalan Sutra 1 Taman Sutra 55100 Kuala Lumpur
The usage of postcode in a state name	No 1 Jalan Ikan Seksyen 20 Shah Alam 40000 Selangor	1, Jalan Ikan Seksyen 20 40300 Shah Alam
Omission of postcode	No 1 Jalan Sutra 1 Taman Sutra Kuala Lumpur	1, Jalan Sutra 1 Taman Sutra 55100 Kuala Lumpur

4.3 International and other usage

For international communication and other usage, a complete address should include the state and the country name as shown below.

EXAMPLE 1, Jalan Sutra 1
Taman Sutra
55100 Kuala Lumpur
Wilayah Persekutuan
Malaysia

4.4 Single address component

A single address component shall be phrased in a single line (see Example).

EXAMPLE

Table 3. Single address component

Address component	Incorrect	Correct
Street	Jalan Sutera 1	Jalan Sutera 1
Building	Menara Raja Muda	Menara Raja Muda
Sub-location	Bangsar Baru	Bangsar Baru

4.5 Usage of comma

For postal purposes, comma should only be used after the premise number. Each address component should continue in a different line (see Example).

EXAMPLE

Table 4. Usage of comma

Incorrect usage of comma for postal purposes	Correct usage of comma for postal purposes
1 Jalan Sutra 1, 55100 Taman Sutra, Kuala Lumpur	1, Jalan Sutra 1 Taman Sutra 55100 Kuala Lumpur

For other usage, a comma may be used to differentiate the address components as shown below:

EXAMPLE 1, Jalan Sutra 1, Taman Sutra, 55100 Kuala Lumpur, Wilayah Persekutuan

4.6 Usage of prefixes

All single information in address should use prefix, as it is the most important identifier to differentiate information in an address (see Example 1 for usage of prefixes and Example 2 for missing prefixes).

EXAMPLE 1

Table 5. Usage of prefixes

Type	Prefixes
Street	Jalan, Lorong
Sub-location	Taman, Garden, Bukit
Building	Menara, Plaza, Bangunan
Post Office Box	PO Box, P.O. Box, Lock Bag
Firm	Syarikat, Sdn Bhd

EXAMPLE 2

Table 6. Missing prefixes

Type address	Incorrect address	Correct address
Street	No 2 SS 14/2 Seksyen 14 40000 Shah Alam	2, Jalan SS 14/2 Seksyen 14 40000 Shah Alam
Building	PKNS Jalan Dato Menteri 40000 Shah Alam	Kompleks PKNS Jalan Dato Menteri 40000 Shah Alam

For a complete list of prefixes, see Annex A.

MS 2039:2006

4.7 Address for parcel or unit in multi-storey building

All addresses should be structured correctly. The format shall be as follow:

X-Y-Z, Menara ABC

where,

X is the building name or number;

Y is the floor/level (including mezzanine floor and basement floor); and

Z is the unit/room/door number.

See Example.

EXAMPLE

Table 7. Address for parcel or unit in multi-storey building

Address type	Incorrect	Correct
Building – Single block	No 3 Menara Kelana Tingkat 2, 379, Jalan Sultan Ismail 50250 Kuala Lumpur	2-3, Menara Kelana 379, Jalan Sultan Ismail 50250 Kuala Lumpur
Building – Multiple block	No 5, Tingkat 7 Blok A1, Pangsapuri Kelana Kelana Jaya 47300 Petaling Jaya No 2, Tingkat 6 Blok Melor, Pangsapuri Impian Kelana Jaya 47300 Petaling Jaya	A1-7-5, Pangsapuri Kelana Kelana Jaya 47300 Petaling Jaya Melor-6-2, Pangsapuri Impian Kelana Jaya 47300 Petaling Jaya
Building – Multiple block First floor	No 5, Ground Floor Blok A1, Pangsapuri Kelana Kelana Jaya 47300 Petaling Jaya	A1-1-5, Pangsapuri Kelana Kelana Jaya 47300 Petaling Jaya
Building – Multiple block Basement floor	No 5, Basement 1 Blok A1, Pangsapuri Kelana Kelana Jaya 47300 Petaling Jaya	A1-B1-5, Pangsapuri Kelana Kelana Jaya 47300 Petaling Jaya
Building – Multiple block Mezzanine floor	No 5, Mezzanine Floor Blok A1, Pangsapuri Kelana Kelana Jaya 47300 Petaling Jaya	A1-M1-5, Pangsapuri Kelana Kelana Jaya 47300 Petaling Jaya

Figure 1 gives further example on the addresses for parcel or unit in multi-storey building.

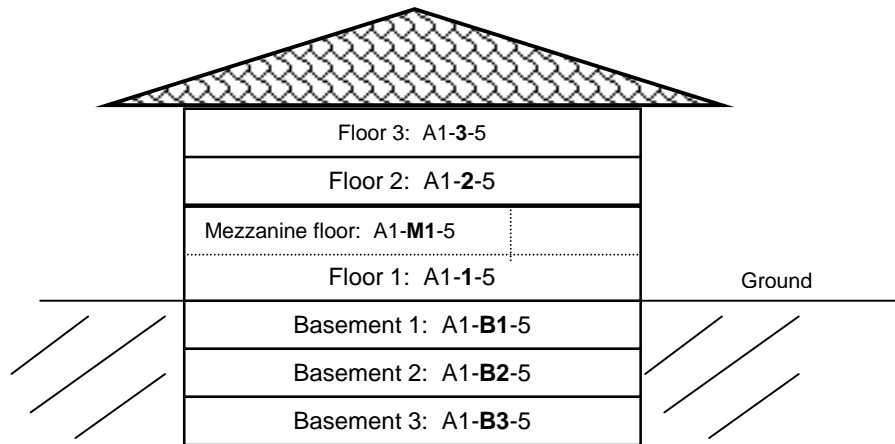

NOTE. According to the strata convention, ground floor is equivalent to first floor.

Figure 1. Strata convention for parcel or unit in multi-storey building

NOTE. For common mistakes used in addresses, see Annex D.

5. Street addresses

5.1 General

This clause establishes the requirements and provides guidelines for a comprehensive street address system. It identifies the elements of the system and provides specific guidelines for the application of those elements to various street patterns and street classifications found in the country. Street addresses apply to all address sites which use a street name as reference item.

5.2 Requirements for street addresses

5.2.1 Basic component of street addresses

See 4.1 for the basic component of street addresses.

5.2.1.1 Street addresses accessed by street name

The street addresses format is to cater for access by street name (see Example).

EXAMPLE

Table 8. Types of street addresses

Types of street address	Street addresses
Street address with street access name and cityname	Receiver name 399, Jalan Tun Razak 56000 Kuala Lumpur
Street address with street access name sub-location name and cityname	Receiver name 399, Jalan Midah 17 Taman Midah 56000 Kuala Lumpur
Street address with street access name, sub-location name, sub-cityname and cityname	Receiver name 399, Jalan Bukit Indah 2/1 Taman Bukit Indah 68000 Ampang

5.2.1.2 Habitation name of street addresses

A street address may also consist of habitation names (see Example).

EXAMPLE

Table 9. Receiver/habitation name for street addresses

Receiver/Habitation name	Street addresses
Individual name only	Encik Ahmad Idris 399, Jalan Cheras 56000 Kuala Lumpur Puan Aminah Mohamad A1-7-5, Pangsapuri Kelana Kelana Jaya 47300 Petaling Jaya
Firm name only	Syarikat ABC Sdn Bhd 399, Jalan Cheras 56000 Kuala Lumpur
Firm located inside a building	XYZ (M) Sdn Bhd 5 th Floor, Wisma ABC 28, Jalan 1/65A 50700 Kuala Lumpur
Government agency name only	Perpustakaan Negara Malaysia 232, Jalan Tun Razak 50572 Kuala Lumpur
Government agency located inside a building	Jabatan Penerangan Tingkat 7, Wisma Bernama 28, Jalan 1/65A 50610 Kuala Lumpur Jabatan Penerangan 7-2, Wisma Bernama 28, Jalan 1/65A 50610 Kuala Lumpur

5.2.2 Punctuation in street name

Punctuation is limited to oblique and hyphens:

- Oblique for fractional addresses: 101, Jalan SS 22/4
- Hyphens for hyphenated addresses: 2-2-10, Flat Sri Kelantan

Hyphens in the address range/number on street name are significant and should not be removed. Hyphens in the sub-location name, sub-cityname and city are not significant and may be replaced with a space (see Example).

EXAMPLE

Table 10. Hyphens in range/number on street name

Unsignificant hyphens in street name or sub-location	Significant hyphens in house number range
1, Jalan KL-Seremban 47500 Subang Jaya 1108, Jalan Besar Taman Al-Ridzuan 68000 Ampang	Hotel Malaysia 67-71, Jalan Bukit Bintang 55100 Kuala Lumpur

5.2.3 Abbreviation

5.2.3.1 Single abbreviations

The prefix of the address should conform to the prefixes and abbreviations as listed in Annex A.

5.2.3.2 Double abbreviations

Abbreviation may only apply to a generic name of a geographical feature being referred in a particular line or hierarchies of the address format. Abbreviation shall not be applied to names given to the geographical feature itself. As an example, an address line “Jalan Taman Desa” may be abbreviated to “Jln Taman Desa” but not “Jln Tmn Desa” or “Jalan Tmn Desa”. Although “Taman” is a geographical feature, it should not be abbreviated in this case, as it constitutes part of a proper name (see Example).

EXAMPLE

Table 11. Double abbreviations

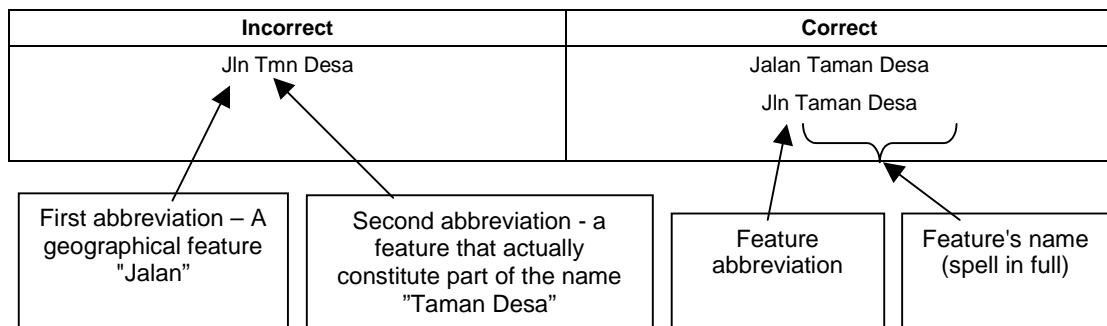

5.2.4 Numeric street names

It is preferred to use numeric value for numeric street name (see Example).

EXAMPLE

Table 12. Numeric street names

Correct
JALAN 7 (full spelling)
JLN 7 (abbreviated spelling)

5.2.5 House number or street number location

A house number should be located in the same line with a street name (see Example).

EXAMPLE

Table 13. House number or street number location

Incorrect	Correct
No 1, Jalan 7	1, Jalan 7

5.3 Application

5.3.1 Street

An address shall use an assigned number based on the house number that has been approved by the authority and should clearly define the starting point at one end of the street as follows:

a) Premise number

Numbers shall be assigned in sequence and shall not be repeated along a specified street. The convention, odd numbers on the left and even numbers on the right hand side when travelling from the starting point, shall be used. The numbers used is in the form of positive integer.

The starting point uses the street hierarchy to determine the sequencing of the premise numbering following the south to north and west to east convention.

b) Naming of roads

Within a locality, and preferably within a council area, unique names shall be allocated to all public roads used to access address sites. Where desirable, private roads should also be named. Where roads cross jurisdiction boundaries, the respective authorities should consult each other to assign a common, unique name to that road.

Where there is a confusion of an identical road name within a jurisdiction area, it is recommended for the local authority to rename one of the roads.

MS 2039:2006

5.3.2 Toll highways

By definition toll highways are controlled access roads. Service centres, weighbridge stations, tollgates and utilities aiding emergency and other essential services shall be addressed to a highway. The address should include the name of the premises and direction of highway or traffic.

5.3.3 Inter-state roads

Addresses on the inter-state roads are usually included in the relevant state authority's classification system. Usually the addresses are known by number and/or description. If there is existence of remote address such as weighbridge station, the respective local authority shall assign a unique name.

6. Non-street addresses

6.1 General

This clause outlines the requirements and guidelines for a non-street address system. It identifies the elements of the system and provides specific guidelines for the application of those elements in a non-street setting.

The objective of non-street address is to provide clear and unambiguous information to users in order to assist them in reaching their desired destination within a non-street setting. The definition of non-street address is an address that does not use a street name as a reference, instead it uses location name as the keyword.

NOTE. For future addressing format, non-street address should be discouraged for database purposes except for prominent or establish institution or agencies.

6.2 Requirements for non-street addresses

6.2.1 Basic component of non-street addresses

See 4.1 for the basic component of non-street addresses.

6.2.1.1 Types of non-street addresses

Different types of non-street addresses are shown in Table 14.

Table 14. Types of non-street addresses

Types of non-street addresses	Example
Non-street address with sub-location name and cityname	Receiver name 399, Taman Miharja 56000 Kuala Lumpur
Non-street address with cityname	Receiver name 50670 Kuala Lumpur NOTE. Receiver name applies to prominent individual or agencies.
Non-street address with sub-location name, sub-cityname and cityname	Receiver name 399, Kampung Pinang Sebatang Sungai Besi 57100 Kuala Lumpur

6.2.1.2 Habitation name of non-street addresses

A non-street address may also consist of habitation names (see Example).

EXAMPLE

Table 15. Receiver/habitation name for non-street addresses

Receiver/Habitation name	Non-street addresses
Individual name only	Encik Ahmad Idris 399, Taman Miharja 56000 Kuala Lumpur Puan Aminah Ali 20, Kampung Masjid 34500 Batu Kurau
Firm name only	Syarikat ABC Sdn Bhd 399, Kampung Pinang Sebatang Sungai Besi 57100 Kuala Lumpur
Firm located inside a building	Unit Kejuruteraan Pos Malaysia Berhad Tingkat 10, Kompleks Dayabumi 50670 Kuala Lumpur
Government agency located inside a building	Bahagian Khidmat Pelanggan Kementerian Penerangan Malaysia Tingkat 7, Angkasapuri 50600 Kuala Lumpur

MS 2039:2006

6.2.2 House number should be located in line with the non-street or premise name.

6.2.3 Non-street prefixes should be used in order to identify this type of address (see Table A3).

7. Post office box addresses

7.1 General

This clause outlines the requirements and guidelines for the post office box addresses system. It identifies the elements of the system and provides specific guidelines for the application of the system. It only applies to those using the post office box address.

7.2 Requirements for post office addresses

7.2.1 Basic component of post office box addresses

See 4.1 for the basic component of post office box addresses (see Example).

EXAMPLE

Table 16. Receiver/habitation name for post office box addresses

Receiver/Habitation name	Post office box addresses
Individual name only	Encik Ahmad Idris P. O. Box 12994 50772 Kuala Lumpur
Firm name only	ABC Berhad Peti Surat 626 46770 Petaling Jaya
Locked bag	Syarikat ABC Sdn Bhd Lock Bag 5676 87897 Kuching

7.2.2 A complete list of post office box prefixes is shown in Table A2.

7.2.3 A postcode number for post office box should used a special assigned postcode number.

7.2.4 Incomplete prefixes cannot be used as prefixes in a post office box address (see Example).

EXAMPLE

Table 17. Incomplete prefixes for post office box address

Incorrect	Correct
Box 12994 50772 Kuala Lumpur	P. O. Box 12994 50772 Kuala Lumpur
P.O. 12994 50772 Kuala Lumpur	P. O. Box 12994 50772 Kuala Lumpur

7.2.5 Post office box number shall be arranged on the second last line of an address.

7.2.6 Format and presentation

The alpha characters should be printed in capital letters (see Example 1). However, Examples 2 and 3 are also acceptable.

EXAMPLE 1 P. O. Box 1234

EXAMPLE 2 P.O. Box 1234

EXAMPLE 3 PO Box 1234

Annex A
(normative)

List of prefixes and abbreviations

Table A1. Street prefixes

Street	Abbreviation
Avenue	Ave.
Close	-
Crescent	-
Drive	-
Foreshore	-
Lane	-
Road	Rd.
Street	St.
Walk	-
Cangkat/Changkat	Chgkt.
Dataran	-
Gat	-
Gerbang	-
Hala	-
Haluan	-
Halaman	-
Konkos	-
Jalan	Jln.
Lorong	Lrg.
Lingkungan /Lengkungan/Lengkongan	-
Lintang	Ltg.
Lintasan	-
Link	-
Lengkok/Lengku	Lnkg.
Lingkar	-
Leboh/Lebuh	Lbh.
Lebohraya/Lebuhraya	-
Laluan	-
Medan	-
Pangkalan/Pengkalan	Pang.
Persisiran	-
Persiaran	Psrn.
Pinggiran	Pgrn.
Pintasan	-
Pintas	-
Pekeliling	-
Solok	-
Selasar	-
Susur	-
Regat	Rgt.

Table A2. Post office box prefixes

Post office box	Abbreviation
Locked Bag	-
Lock Bag	-
Karung Berkunci	-
PO Box	-
P.O. Box	-
Peti Surat	-

Table A3. Locality prefixes

Locality	Abbreviation
Estate	-
Garden	Gdn.
Hill	
Park	-
Settlement	-
Town	-
Village	-
Bagan	-
Bandar	Bdr.
Bukit	Bkt.
Desa	-
FELCRA	FELCRA
FELDA	FELDA
Gunung	G.
Hilir	Hr.
Hulu	H.
Jeram	J.
Kampong/Kampung	Kg., Kpg.
Kepulauan	Kep.
Kuala	K.
Ladang	Ldg.
Lapangan	Lpg.
Lembah	Lmbh.
Kawasan	-
Mukim	-
Muara	Mu.
Padang	Pdg.
Parit	Pt.
Pasir	Psr.
Pekan	-
Pujut	-

Table A3. Locality prefixes (continued)

Locality	Abbreviation
Pelabuhan	Plbh.
Permatang	Pmtg.
Perhentian	Ph.
Perumahan	-
Pulau	P.
Sungai	Sg.
Taman	Tmn.
Tanah	Tnh.
Tanjung	Tg.
Tali Air	T.A.
Teluk/Telok	Tlk.

Table A4. Government prefixes

Government	Abbreviation
Balai Polis	B.P.
Balai Raya	B.R.
Jabatan	-
Kementerian	-
Pejabat	-
Projek	-
Suruhanjaya	-

Table A5. Firm abbreviation

Firm	Abbreviation
Bank	-
Company	Co.
Construction	-
Enterprise	-
Finance	-
Limited	Ltd.
Trading	-
Trade	-
Works	-
Workshop	-
Berhad	Bhd.
Hospital	Hosp.
Klinik	-
Koperasi	-
Sendirian Berhad	Sdn. Bhd.

Table A6. Building abbreviation

Building	Abbreviation
Apartment/Apartments	Apt.
Building	Bld.
Block	Blk.
Barrack	-
Center/Centre	Ctr.
Complex	-
Condominium	Condo.
Court/Courts	-
Highschools	-
Heights	-
Quarters	Qtrs.
School	Sch.
Square	Sq.
Station	-
Tower	-
Bangunan	Bgn.
Bazar	-
Blok	Blk.
Dewan	-
Flat	-
Hotel	-
Kolej	-
Kompleks	-
Kondominium	Kondo.
Kedai	-
Kuarters	-
Menara	-
Plaza	-
Pangsapuri	-
Rumah	-
Rumah pangsa	-
Sekolah	S.
Stor	-
Wisma	-

Table A7. Other abbreviation

Other abbreviation	Abbreviation
Bahagian	Bhg.
Floor	Flr.
Level	Lvl.
Tingkat	Tkt.

Annex B
(normative)

Postcode system

B1. The assignment of postcode number for post offices and delivery branches are shown in the table below:

Table B1. Postcode assignment

State		Mail circulation area		First two digits
Name	Serial no.	Main concentration office	Small concentration office	
Perlis	01-03	Kangar	Kangar (Forward)	01 02
Kedah	04-09	Alor Setar	Alor Setar (Forward) Pulau Langkawi Sungai Petani Kulim	05 06 07 08 09
Pulau Pinang	10-14	Georgetown Butterworth	Georgetown (Forward) Butterworth (Forward) Bukit Mertajam	10 11 12 13 14
Kelantan	15-19	Kota Bharu	Kota Bharu (Forward) Pasir Mas ^a Kuala Krai ^a	15 16 17 18
Terengganu	20-24	Kuala Terengganu	Kuala Terengganu (Forward) Jerteh ^a Dungun ^a Kemaman ^a	20 21 22 23 24
Pahang	25-29	Kuantan	Kuantan (Forward) Jerantut Mentakab	25 26 27 28
Perak	30-39	Ipoh	Ipoh (Forward) Sitiawan Kuala Kangsar Taiping Tapah Teluk Intan Cameron Highlands (Pahang)	30 31 32 33 34 35 36 39

Table B1. Postcode assignment (continued)

State		Mail circulation area		First two digits
Name	Serial no.	Main concentration office	Small concentration office	
Selangor	40-49	Shah Alam Kelang	Kelang (Forward)	40
				41
		Petaling Jaya	Kajang ^a	42
			Kuala Kubu Baru ^a	43
			Kuala Selangor ^a	44
			Petaling Jaya (Forward)	45
				46
				47
				48
			49	
Wilayah Persekutuan Kuala Lumpur	50-69	P.P.B, K.L Sentul Jinjang Gombak Gurney Pudu Cheras Sungai Besi Jalan Klang Lama Pantai Baru Taman Tun Dr. Ismail		50
				51
				52
				53
				54
				55
				56
				57
				58
				59
	60			
	68			
	69			
		P.P.B, K.L (Selangor area) P.P.B, K.L (Selangor area)		
Negeri Sembilan	70-74	Seremban	Seremban (Forward)	70
				71
			Kuala Pilah ^a	72
			Tampin	73
Melaka	75-78	Melaka	Melaka (Forward)	75
				76
			Jasin ^a	77
			Alor Gajah ^a	78
Johor	79-86	Johor Bahru	Johor Bahru (Forward)	80
				81
			Pontian ^a	82
			Batu Pahat	83
			Muar ^a	84
			Segamat ^a	85
			Kluang	86
Sabah and Labuan	87-92	Kota Kinabalu	Labuan	87
				88
			Kota Kinabalu (Forward)	89
			Sandakan ^a	90
			Tawau ^a	91

Table B1. Postcode assignment (continued)

State		Mail circulation area		First two digits
Name	Serial no.	Main concentration office	Small concentration office	
Sarawak	93-99	Kuching	Kuching (Forward)	93
			Sri Aman ^a	94
			Sibu ^a	95
			Bintulu ^a	96
			Miri ^a	97
				98
^a Mail concentration office				

B2. Postcode number for main concentration offices

B2.1 For the main concentration offices, first two-digit postcode number identifies the post office (see Example).

EXAMPLE

05xxx	Alor Setar's General Post Office
10xxx	Pulau Pinang's General Post Office
12xxx	Butterworth's Post Office
20xxx	Kuala Terengganu's General Post Office
50xxx	Kuala Lumpur's General Post Office
51xxx	Sentul's Post Office
93xxx	Kuching's General Post Office

B2.2 Last three-digits postcode numbers are:

xx000 to xx499	For street delivery zone. Street delivery zone is defined as a group of delivery bit (normally between 5 and 10 bit).
xx500 to xx699	For government agency which received an average of 100 mails per day.
xx700 to xx899	For a group of post office boxes (P.O. Box).
xx900 to xx989	For Personal post office box which received an average of 500 mails per day.
xx990 to xx999	For locked bag services.

B2.3 Hence,

12100	Street delivery zone for Butterworth's General Post Office
05600	Government agency delivery for Alor Star's General Post Office
50780	A group of personal post office box for Kuala Lumpur's General Post Office
93910	A personal post office box for Kuching's General Post Office

B2.4 For government agencies, which are assigned with a special postcode number, a same department from different states should have the same last three-digit postcode numbers (see Example).

Jabatan Kerja Raya Kuala Lumpur	50582 Kuala Lumpur
Jabatan Kerja Raya Johor Bahru	80582 Johor Bahru
Jabatan Kerja Raya Petaling Jaya	46582 Petaling Jaya
Jabatan Kerja Raya Kuching	93582 Kuching

B3. Postcode number for delivery post office branches

B3.1 For delivery post office branches, the first two-digit postcode number identifies the small concentration office (see Example).

EXAMPLE

02xxx	For Kangar
14xxx	For Bukit Mertajam
73xxx	For Tampin
90xxx	For Sandakan

B3.2 The third and fourth digits postcode number identifies the delivery post office, which received mails from the main concentration office (see Example).

EXAMPLE

1400x	For Bukit Mertajam's Post Office (Inward)
1401x	For Guar Perahu's Post Office
1402x	For Machang Bubok's Post Office
1410x	For Simpang Ampat's Post Office
1420x	For Sungai Jawi's Post Office
1430x	For Nibong Tebal's Post Office

MS 2039:2006

B3.3 The last fifth digit in the postcode number means:

xxxx0 to xxxx4 for street delivery zones
xxxx5 to xxxx6 for government agencies
xxxx7 to xxxx8 for a personal post office boxes
xxxx9 for locked bag services

B3.4 Hence,

1400x	Street delivery for Bukit Mertajam's Post Office
14005	Government agencies delivery for Bukit Mertajam's Post Office
14007	Personal post box delivery for Bukit Mertajam's Post Office
14009	Locked bag services for Bukit Mertajam's Post Office

NOTE. Annex B is taken from the post office guide documentation (*Sistem Poskod Kebangsaan*, 1985).

Annex C
(normative)

List of postcode number

Table C1. List of postcode number

Cityname	State	Postcode
Ayer Baloi	Johor	82100
Ayer Hitam	Johor	86100
Bakri	Johor	84200
Batu Anam	Johor	85100
Batu Pahat	Johor	83000
Bekok	Johor	86500
Benut	Johor	82200
Bukit Gambir	Johor	84800
Bukit Pasir	Johor	84300
Chaah	Johor	85400
Endau	Johor	86900
Gelang Patah	Johor	81550
Gerisek	Johor	84700
Gugusan Taib Andak	Johor	81450
Jementah	Johor	85200
Johor Bahru	Johor	80000
Johor Bahru	Johor	81200
Kahang	Johor	86700
Kg Kenangan Tun Dr Ismail	Johor	84100
Kluang	Johor	86000
Kota Tinggi	Johor	81900
Kukup	Johor	82300
Kulai	Johor	81000
Labis	Johor	85300
Layang Layang	Johor	81850
Masai	Johor	81750
Mersing	Johor	86800
Muar	Johor	84000
Pagoh	Johor	84600
Paloh	Johor	86600
Panchor	Johor	84500
Parit Jawa	Johor	84150
Parit Raja	Johor	86400
Parit Sulong	Johor	83500
Pasir Gudang	Johor	81700
Pekan Nanas	Johor	81500
Pengerang	Johor	81600
Pontian	Johor	82000
Rengam	Johor	86300
Rengit	Johor	83100
Segamat	Johor	85000
Semerah	Johor	83600
Senai	Johor	81400
Senggarang	Johor	83200
Seri Gading	Johor	83300
Simpang Rengam	Johor	86200
Sungai Mati	Johor	84400

Table C1. List of postcode number (continued)

Cityname	State	Postcode
Tangkak	Johor	84900
Ulu Tiram	Johor	81800
Yong Peng	Johor	83700
Alor Setar	Kedah	05300
Ayer Hitam	Kedah	06150
Baling	Kedah	09100
Bandar Baharu	Kedah	34950
Bedong	Kedah	08100
Bukit Kayu Hitam	Kedah	06050
Kepala Batas	Kedah	06200
Kodiang	Kedah	06100
Kota Kuala Muda	Kedah	08500
Kota Sarang Semut	Kedah	06800
Kuala Kedah	Kedah	06600
Kuala Ketil	Kedah	09300
Kuala Nerang	Kedah	06300
Kulim	Kedah	09000
Kupang	Kedah	09200
Langgar	Kedah	06500
Langkawi	Kedah	07000
Lunas	Kedah	09600
Merbok	Kedah	08400
Padang Serai	Kedah	09400
Pendang	Kedah	06720
Pokok Sena	Kedah	06350
Serdang	Kedah	09800
Sik	Kedah	08210
Simpang Empat	Kedah	06650
Sungai Petani	Kedah	08010
Universiti Utara Malaysia	Kedah	06010
Yan	Kedah	06900
Ayer Lanas	Kelantan	17700
Bachok	Kelantan	16300
Cherang Ruku	Kelantan	16700
Dabong	Kelantan	18200
Gua Musang	Kelantan	18300
Jeli	Kelantan	17600
Kem Desa Pahlawan	Kelantan	16500
Ketereh	Kelantan	16450
Kota Bharu	Kelantan	16100
Kuala Balah	Kelantan	17610
Kuala Krai	Kelantan	18000
Machang	Kelantan	18500
Melor	Kelantan	16400
Pasir Mas	Kelantan	17000
Pasir Puteh	Kelantan	16800
Pulai Chondong	Kelantan	16600
Rantau Panjang	Kelantan	17200
Selising	Kelantan	16810
Tanah Merah	Kelantan	17500
Temangan	Kelantan	18400
Tumpat	Kelantan	16210
Wakaf Bharu	Kelantan	16250
Alor Gajah	Melaka	78000
Asahan	Melaka	77100
Bemban	Melaka	77200

Table C1. List of postcode number (continued)

Cityname	State	Postcode
Durian Tunggal	Melaka	76100
Jasin	Melaka	77000
Kuala Sungai Baru	Melaka	78200
Lubok China	Melaka	78100
Masjid Tanah	Melaka	78300
Melaka	Melaka	75460
Merlimau	Melaka	77300
Selandar	Melaka	77500
Sungai Rambai	Melaka	77400
Sungai Udang	Melaka	76300
Tanjong Kling	Melaka	76400
Tanjong Kling	Melaka	76409
Bahau	Negeri Sembilan	72100
Bandar Baru Serting	Negeri Sembilan	72120
Batang Melaka	Negeri Sembilan	73300
Batu Kikir	Negeri Sembilan	72200
Gemas	Negeri Sembilan	73400
Gemencheh	Negeri Sembilan	73200
Johol	Negeri Sembilan	73100
Juasseh	Negeri Sembilan	72500
Kota	Negeri Sembilan	71350
Kuala Klawang	Negeri Sembilan	71600
Kuala Pilah	Negeri Sembilan	72000
Labu	Negeri Sembilan	71900
Lenggeng	Negeri Sembilan	71750
Linggi	Negeri Sembilan	71150
Mantin	Negeri Sembilan	71700
Nilai	Negeri Sembilan	71800
Pasir Panjang	Negeri Sembilan	71250
Pedas	Negeri Sembilan	71400
Port Dickson	Negeri Sembilan	71000
Rantau	Negeri Sembilan	71200
Rembau	Negeri Sembilan	71300
Rompin	Negeri Sembilan	73500
Seremban	Negeri Sembilan	70400
Si Rusa	Negeri Sembilan	71050
Siliau	Negeri Sembilan	71100
Simpang Durian	Negeri Sembilan	72400
Simpang Pertang	Negeri Sembilan	72300
Sri Menanti	Negeri Sembilan	71550
Tampin	Negeri Sembilan	73000
Tanjong Ipoh	Negeri Sembilan	71500
Titi	Negeri Sembilan	71650
Balok	Pahang	26190
Bandar Pusat Jengka	Pahang	26400
Bandar Tun Abdul Razak	Pahang	26900
Benta	Pahang	27300
Bentong	Pahang	28700
Brinchang	Pahang	39100
Bukit Fraser	Pahang	49000
Chenor	Pahang	28100
Chini	Pahang	26690
Damak	Pahang	27030
Dong	Pahang	27400
Gambang	Pahang	26300

Table C1. List of postcode number (continued)

Cityname	State	Postcode
Genting Highlands	Pahang	69000
Jerantut	Pahang	27000
Karak	Pahang	28620
Kemayan	Pahang	28380
Kuala Krau	Pahang	28050
Kuala Lipis	Pahang	27200
Kuala Rompin	Pahang	26800
Kuantan	Pahang	25200
Lanchang	Pahang	28500
Lurah Bilut	Pahang	28800
Maran	Pahang	26500
Mengkarak	Pahang	28200
Mentakab	Pahang	28400
Muadzam Shah	Pahang	26700
Padang Tengku	Pahang	27100
Pekan	Pahang	26650
Raub	Pahang	27610
Ringlet	Pahang	39200
Sega	Pahang	27660
Sungai Koyan	Pahang	27650
Sungai Lembing	Pahang	26200
Sungai Ruan	Pahang	27500
Tanah Rata	Pahang	39000
Temerloh	Pahang	28000
Triang	Pahang	28300
Ayer Tawar	Perak	32400
Bagan Datoh	Perak	36100
Bagan Serai	Perak	34300
Batu Gajah	Perak	31000
Batu Kurau	Perak	34500
Behrang Stesen	Perak	35950
Beruas	Perak	32700
Bidor	Perak	35500
Bota	Perak	32600
Changkat Jering	Perak	34850
Changkat Keruing	Perak	32500
Chemor	Perak	31200
Chenderiang	Perak	35300
Chenderong Balai	Perak	36600
Chikus	Perak	36750
Eggong	Perak	33600
Gerik	Perak	33300
Gopeng	Perak	31610
Hutan Melintang	Perak	36400
Intan	Perak	33200
Ipoh	Perak	31400
Jeram	Perak	31850
Kampar	Perak	31900
Kampung Gajah	Perak	36800
Kampung Kepayang	Perak	31300
Kamunting	Perak	34600
Kuala Kangsar	Perak	33040
Kuala Kurau	Perak	34350
Kuala Sepetang	Perak	34650
Lahat	Perak	31500
Lambor Kanan	Perak	32900

Table C1. List of postcode number (continued)

Cityname	State	Postcode
Langkap	Perak	36700
Lenggong	Perak	33410
Lumut	Perak	32200
Malim Nawar	Perak	31700
Mambang Diawan	Perak	31950
Manong	Perak	33800
Matang	Perak	34750
Menglembu	Perak	31450
Padang Rengas	Perak	33700
Pangkor	Perak	32300
Pantai Remis	Perak	34900
Parit	Perak	32800
Parit Buntar	Perak	34200
Pengkalan Hulu	Perak	33100
Pusing	Perak	31550
Rantau Panjang	Perak	34140
Sauk	Perak	33500
Selama	Perak	34100
Selekoh	Perak	36200
Seri Manjong	Perak	32040
Simpang	Perak	34700
Simpang Ampat Semanggol	Perak	34400
Sitiawan	Perak	32000
Slim River	Perak	35800
Sungai Siput	Perak	31100
Sungai Sumun	Perak	36300
Sungkai	Perak	35600
Taiping	Perak	34000
Tanjong Malim	Perak	35900
Tanjong Piandang	Perak	34250
Tanjong Rambutan	Perak	31250
Tanjong Tualang	Perak	31800
Tapah	Perak	35000
Tapah Road	Perak	35400
Teluk Intan	Perak	36000
Temoh	Perak	35350
TLDM Lumut	Perak	32100
Trolak	Perak	35700
Trong	Perak	34800
Tronoh	Perak	31750
Ulu Bernam	Perak	36500
Ulu Kinta	Perak	31150
Arau	Perlis	02600
Kaki Bukit	Perlis	02200
Kangar	Perlis	01000
Kuala Perlis	Perlis	02000
Padang Besar	Perlis	02100
Simpang Ampat	Perlis	02700
Ayer Itam	Pulau Pinang	11500
Balik Pulau	Pulau Pinang	11000
Batu Feringgi	Pulau Pinang	11100
Batu Maung	Pulau Pinang	11960
Bayan Lepas	Pulau Pinang	11950
Bukit Mertajam	Pulau Pinang	14000
Butterworth	Pulau Pinang	12300
Gelugor	Pulau Pinang	11700

Table C1. List of postcode number (continued)

Cityname	State	Postcode
Kepala Batas	Pulau Pinang	13200
Kubang Semang	Pulau Pinang	14400
Nibong Tebal	Pulau Pinang	14300
Penaga	Pulau Pinang	13110
Penang Hill	Pulau Pinang	11300
Perai	Pulau Pinang	13700
Permatang Pauh	Pulau Pinang	13500
Pulau Pinang	Pulau Pinang	10470
Simpang Ampat	Pulau Pinang	14100
Sungai Jawi	Pulau Pinang	14200
Tanjong Bungah	Pulau Pinang	11200
Tasek Gelugor	Pulau Pinang	13300
USM Pulau Pinang	Pulau Pinang	11800
Beaufort	Sabah	89808
Beluran	Sabah	90100
Bongawan	Sabah	89700
Keningau	Sabah	89000
Kota Belud	Sabah	89150
Kota Kinabalu	Sabah	88300
Kota Kinabatangan	Sabah	90200
Kota Marudu	Sabah	89100
Kuala Penyu	Sabah	89740
Kudat	Sabah	89050
Kunak	Sabah	91200
Labuan	Sabah	87000
Lahad Datu	Sabah	91100
Membakut	Sabah	89720
Menumbok	Sabah	89760
Nabawan	Sabah	89950
Pamol	Sabah	90400
Papar	Sabah	89600
Penampang	Sabah	89500
Ranau	Sabah	89300
Sandakan	Sabah	90000
Semporna	Sabah	91307
Sipitang	Sabah	89850
Tambunan	Sabah	89650
Tamparuli	Sabah	89250
Tawau	Sabah	91000
Tenom	Sabah	89900
Tuaran	Sabah	89200
Asajaya	Sarawak	94600
Balingian	Sarawak	96350
Baram	Sarawak	98050
Bau	Sarawak	94000
Bekenu	Sarawak	98150
Belaga	Sarawak	96900
Belawai	Sarawak	96150
Betong	Sarawak	95700
Bintangor	Sarawak	96500
Bintulu	Sarawak	97000
Dalat	Sarawak	96300
Daro	Sarawak	96200
Debak	Sarawak	95500
Engkilili	Sarawak	95800
Julau	Sarawak	96600

Table C1. List of postcode number (continued)

Cityname	State	Postcode
Kabong	Sarawak	94650
Kanowit	Sarawak	96700
Kapit	Sarawak	96800
Kota Samarahan	Sarawak	94300
Kuching	Sarawak	93450
Lawas	Sarawak	98850
Limbang	Sarawak	98700
Lingga	Sarawak	94900
Long Lama	Sarawak	98300
Lubok Antu	Sarawak	95900
Lundu	Sarawak	94500
Lutong	Sarawak	98100
Matu	Sarawak	96250
Miri	Sarawak	98000
Mukah	Sarawak	96400
Nanga Medamit	Sarawak	98750
Niah	Sarawak	98200
Pusa	Sarawak	94950
Roban	Sarawak	95300
Saratok	Sarawak	95400
Sarikei	Sarawak	96100
Sebauh	Sarawak	97100
Sebuyau	Sarawak	94850
Serian	Sarawak	94700
Sibu	Sarawak	96000
Simunjan	Sarawak	94800
Song	Sarawak	96850
Spaoh	Sarawak	95600
Sri Aman	Sarawak	95000
Sundar	Sarawak	98800
Tanjung Kidurong	Sarawak	97300
Tatau	Sarawak	97200
Ampang	Selangor	68000
Bandar Baru Bangi	Selangor	43650
Banting	Selangor	42700
Batang Berjuntai	Selangor	45600
Batang Kali	Selangor	44300
Batu 9 Cheras	Selangor	43200
Batu Arang	Selangor	48100
Batu Caves	Selangor	68100
Beranang	Selangor	43700
Bukit Rotan	Selangor	45700
Cyberjaya	Selangor	63000
Dengkil	Selangor	43800
Hulu Langat	Selangor	43100
Jenjarom	Selangor	42600
Jeram	Selangor	45800
Kajang	Selangor	43000
Kapar	Selangor	42200
Kerling	Selangor	44100
Klang	Selangor	42450
KLIA	Selangor	64000
Kuala Kubu Baru	Selangor	44020
Kuala Kubu Baru	Selangor	44110
Kuala Selangor	Selangor	45000
Pelabuhan Klang	Selangor	42000

Table C1. List of postcode number (continued)

Cityname	State	Postcode
Petaling Jaya	Selangor	47400
Puchong	Selangor	47100
Pulau Carey	Selangor	42960
Pulau Ketam	Selangor	42940
Pulau Lumut	Selangor	42920
Putrajaya	Selangor	62000
Rasa	Selangor	44200
Rawang	Selangor	48010
Sabak Bernam	Selangor	45200
Sekinchan	Selangor	45400
Semenyih	Selangor	43500
Sepang	Selangor	43900
Serendah	Selangor	48200
Seri Kembangan	Selangor	43300
Shah Alam	Selangor	40160
Subang Jaya	Selangor	47500
Sungai Ayer Tawar	Selangor	45100
Sungai Besar	Selangor	45300
Sungai Buloh	Selangor	47000
Sungai Pelek	Selangor	43950
Tanjong Karang	Selangor	45500
Tanjong Sepat	Selangor	42800
Telok Panglima Garang	Selangor	42500
UKM Bangi	Selangor	43600
UPM Serdang	Selangor	43400
Ajil	Terengganu	21800
Al Muktafi Billah Shah	Terengganu	23400
Bukit Besi	Terengganu	23200
Cukai	Terengganu	24000
Dungun	Terengganu	23000
Jerteh	Terengganu	22000
Kampong Raja	Terengganu	22200
Kemasek	Terengganu	24200
Kerteh	Terengganu	24300
Ketengah Jaya	Terengganu	23300
Kijal	Terengganu	24100
Kuala Berang	Terengganu	21700
Kuala Besut	Terengganu	22300
Kuala Terengganu	Terengganu	21070
Marang	Terengganu	21600
Paka	Terengganu	23100
Permaisuri	Terengganu	22100
Kuala Lumpur	Wilayah Persekutuan	52200
Kuala Lumpur	Wilayah Persekutuan	50000
Kuala Lumpur	Wilayah Persekutuan	50050
Kuala Lumpur	Wilayah Persekutuan	50100
Kuala Lumpur	Wilayah Persekutuan	50150
Kuala Lumpur	Wilayah Persekutuan	50250
Kuala Lumpur	Wilayah Persekutuan	50300
Kuala Lumpur	Wilayah Persekutuan	50350
Kuala Lumpur	Wilayah Persekutuan	50400
Kuala Lumpur	Wilayah Persekutuan	50450
Kuala Lumpur	Wilayah Persekutuan	50460

Table C1. List of postcode number (continued)

Cityname	State	Postcode
Kuala Lumpur	Wilayah Persekutuan	50470
Kuala Lumpur	Wilayah Persekutuan	50480
Kuala Lumpur	Wilayah Persekutuan	50490
Kuala Lumpur	Wilayah Persekutuan	51000
Kuala Lumpur	Wilayah Persekutuan	51100
Kuala Lumpur	Wilayah Persekutuan	51200
Kuala Lumpur	Wilayah Persekutuan	52000
Kuala Lumpur	Wilayah Persekutuan	52100
Kuala Lumpur	Wilayah Persekutuan	53000
Kuala Lumpur	Wilayah Persekutuan	53100
Kuala Lumpur	Wilayah Persekutuan	53200
Kuala Lumpur	Wilayah Persekutuan	53300
Kuala Lumpur	Wilayah Persekutuan	54000
Kuala Lumpur	Wilayah Persekutuan	54100
Kuala Lumpur	Wilayah Persekutuan	54200
Kuala Lumpur	Wilayah Persekutuan	55100
Kuala Lumpur	Wilayah Persekutuan	55200
Kuala Lumpur	Wilayah Persekutuan	55300
Kuala Lumpur	Wilayah Persekutuan	56000
Kuala Lumpur	Wilayah Persekutuan	56100
Kuala Lumpur	Wilayah Persekutuan	57000
Kuala Lumpur	Wilayah Persekutuan	57100
Kuala Lumpur	Wilayah Persekutuan	58000
Kuala Lumpur	Wilayah Persekutuan	58100
Kuala Lumpur	Wilayah Persekutuan	58200
Kuala Lumpur	Wilayah Persekutuan	59000
Kuala Lumpur	Wilayah Persekutuan	59100
Kuala Lumpur	Wilayah Persekutuan	59200

NOTE. Complete list of postcode number could be referred from "Poskod Malaysia" published by Pos Malaysia Berhad or access the website at <http://www.pos.com.my/ePostcode/public/mainpage.htm>.

Annex D (normative)

Common mistakes used in addresses

D1. Underlined and guided address

For postal purposes, underlined or guided address should not be used (see Example).

EXAMPLE

Table D1. Common mistake for underlined and guided address in postal purposes

Type	Example
Underlined address	<u>Syarikat AB Sdn Bhd</u> <u>23 Jalan Raja</u> <u>50000 Kuala Lumpur</u>
Guided address	Syarikat AB Sdn Bhd <i>(company name)</i> 23, Jalan Raja <i>(street name)</i> 50000 Kuala Lumpur <i>(cityname)</i>

Underlined or guided address is allowed in other forms or format used by commercial or government sectors.

D2. English and other foreign translation

English and other foreign translation in an address should be avoided to prevent confusion of name in a registered address database (see Example).

EXAMPLE

Table D2. Common mistake for English translation

Incorrect address (using English translation)	Correct address
5, Main Street Angsana Garden 56100 Kuala Lumpur	5, Jalan Besar Taman Angsana 56100 Kuala Lumpur

D3. Using “off street” address

“Off street” shall not be used (see Example).

EXAMPLE

Table D3. Common mistake for "off street" address

Incorrect address (using "off street")	Correct address
1, Jalan Ipoh Kecil Off Jalan Ipoh 51200 Kuala Lumpur	1, Jalan Ipoh Kecil 51200 Kuala Lumpur

D4. Dual address

Dual address shall not be used (see Example).

EXAMPLE

Table D4. Common mistake for dual address

Incorrect	Correct	
	Post office box address	Street address
XYZ Berhad Menara ABC 100, Jalan Tun Perak PO Box 10643 50936 Kuala Lumpur	XYZ Berhad PO Box 10643 50936 Kuala Lumpur	XYZ Berhad Menara ABC 100, Jalan Tun Perak 50050 Kuala Lumpur

D5. Milestone location

The milestone location address (e.g. *batu* or kilometre) shall not be used for the future street addressing format (see Example).

EXAMPLE

Table D5. Milestone location

Address type	Incorrect	Correct
Street address	2, Jalan Ipoh Batu 4 ½ 50250 Kuala Lumpur	2, Batu 4 ½, Jalan Ipoh 50250 Kuala Lumpur

NOTE. The current usage of milestone location address should be maintained until it is being gazetted by the relevant authority.

MS 2039:2006

Bibliography

Geography Names Determination Guideline, Committee on National Geographic Name
(*Jawatankuasa Kebangsaan Nama Geografi*)

Acknowledgements

Technical Committee on Geographic Information/Geomatics members:

Dato' Dr Abdul Kadir Abu Taib (Chairman)	Department of Survey and Mapping Malaysia
Puan Siti Mariam Haji Rahmat (Secretary)	SIRIM Berhad
Encik Hasan Jamil	Department of Survey and Mapping Malaysia (Wilayah Persekutuan)
Encik Teng Chee Boo	Department of Survey and Mapping Malaysia (Mapping Services)
Tuan Haji Kamali Adimin	Department of Survey and Mapping Malaysia (Cartography)
Encik Daniel Boey	ESRI South Asia Sdn Bhd
Dr Noordin Ahmad	Geo-Info Services
Encik Mansor Abd Rahaman	Malaysian Access Centre and Remote Sensing
Dr Muhamad Radzali Mispan	Malaysian Agriculture Research and Development Institute
Encik Mazlan Asha'ri	Malaysian Centre for Geospatial Data Infrastructure
Puan Fuziah Haji Abu Hanifah	Ministry of Natural Resources and Environment
Ir Muhammad Rahimi Abdullah	Public Work Department
Encik Mohd Ali Abu Bakar	Town and Country Planning Department
Assoc Prof Dr Wan Muhammad Aminuddin	Universiti Sains Malaysia (School of Civil Engineering)
Prof Dr Ruslan Rainis	Universiti Sains Malaysia (School of Humanities)
Encik Mohamad Ghazali Hashim	Universiti Teknologi Malaysia

Working Group on Route Information, Guide Signs and Addresses members:

Ir Dr Safry Kamal Haji Ahmad (Chairman)	Public Work Department
Ir Kamar Kassim (Former Chairman)	Public Work Department
Cik Salwa Denan (Secretary)	SIRIM Berhad
Encik Ahmed Ismail Haji Amin	Automobile Association of Malaysia
Encik Wan Zainuddin Wan Yusoff/	Department of Survey and Mapping Malaysia
Encik Mohamed Sofian Abu Talib	
Encik Daniel Boey	ESRI South Asia Sdn Bhd
Encik Mhd Khair Nordin	Ministry of Housing and Local Government
Encik Asmadi Surat	Pos Malaysia Berhad
Ir Abdul Rahman Baharuddin/	Public Work Department
Encik Ismail Mohamad	
Encik Razali Che Embi	Road Engineering Association of Malaysia
Ir Umi Kalthom Ahmad	Subang Jaya Municipal Council
Cik Suraya Badaruddin/	Town and Country Planning Department
Puan Noraziah Abdul Aziz	
Prof Ir Mohamed Rehan Karim	Universiti Malaya
Dr Shattri Mansor	Universiti Putra Malaysia
Encik Zamri Ismail/	Universiti Teknologi Malaysia
Encik Ivin Amri Musliman	